

POSSIBLE APPLICATIONS FOR VarioSpray HP

Application of oil for applying seasonings

Oils are generally applied so that products can adhere (e.g. seasonings to cereals/snacks). With **VarioSpray HP**, this can be performed without aerosols. This means a significant reduction in operating costs and the necessary cleaning processes.



Web humidification

Individual valve controls permit flexible response to changes in product moisture (for example, on paper webs or non-woven fabrics) and improvements in product quality.

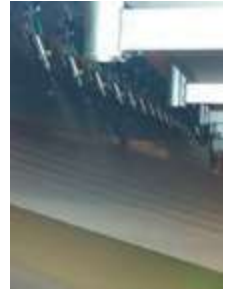

Release agent application for more viscous media

The application of demolding oils, anti-corrosion agents, or other release agents often requires costly extraction systems. With **VarioSpray HP**, these systems can be kept to a minimum or even eliminated altogether. At the same time, the media is more evenly applied to the product.



Coating of foods

With **VarioSpray HP**, commonly used liquids such as sugar solutions containing vitamins or liquid egg can be efficiently sprayed onto the product with practically no loss.



Optimization of the production process



Moisture loss resulting from freezing can be precisely compensated by applying water. You will notice immediate, measurable success in the optimization of your production processes.

VarioSpray HP



The HP valve range can be used to atomize a wide variety of liquids. All parts that come into contact with liquids are made of stainless steel, thereby complying with EC 1935/2004 and FDA regulations.



Suitable for the following viscosities in mPas*

Ordering no.: 752.060.1Y.00	0	10	20	30	40	50	60	70	80	90
---------------------------------------	---	----	----	----	----	----	----	----	----	----

Ordering no.: 752.090.1Y.00	0	10	20	30	40	50	60	70	80	90
---------------------------------------	---	----	----	----	----	----	----	----	----	----

Valve	752.060.1Y.00	752.090.1Y.00
Type	2/2-way N.C.	2/2-way N.C.
Nominal diameter	0.6 mm	0.9 mm
Pressure range	10 bar	7 bar
Voltage	12 V DC	
Nominal power	9 W	
Control	Peak & Hold Control only	
Housing material	316L SS	
Spring material	301 SS	
Protection type	IP 65	
Frequency	0 – 200 Hz	
Hose connection	Push-in dia. 8 mm	
Electrical connection	M8 3-pin circular connector	

* Depending on the density of the liquid

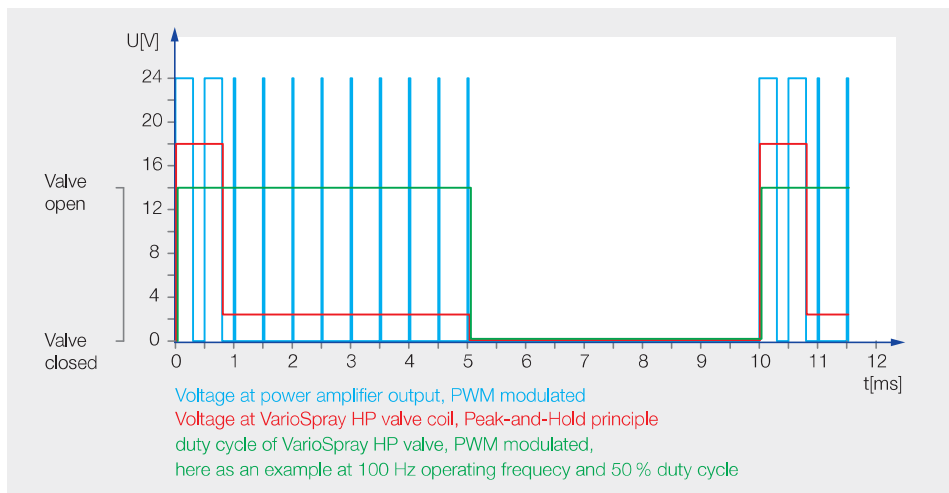
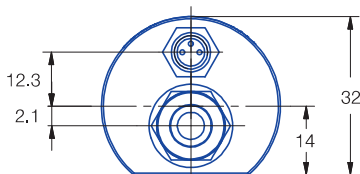
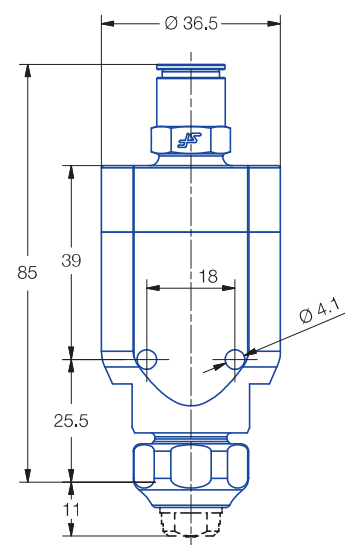

Spray angle**	Ordering no.	Material			Suitable for valves		Flow rate range***	
		16	17	56	752.060.1Y	752.090.1Y	l/min	l/min
		303 SS	316Ti SS/ 316L SS	POM			752.060.1Y	752.090.1Y
60°	652.304.WW.05	○	○	–	–	○	–	0.09 – 0.55
	652.334.WW.05	○	○	–	–	○	–	0.11 – 0.71
	652.364.WW.05	○	○	–	–	○	–	0.13 – 0.91
75°	652.145.WW.05	○	–	○	○	○	0.02 – 0.10	0.02 – 0.10
	652.165.WW.05	○	–	–	○	○	0.02 – 0.12	0.02 – 0.12
	652.185.WW.05	○	–	○	○	○	0.02 – 0.15	0.03 – 0.16
	652.215.WW.05	○	–	–	○	○	0.03 – 0.19	0.04 – 0.20
	652.245.WW.05	○	–	–	○	○	0.04 – 0.26	0.05 – 0.28
	652.275.WW.05	○	–	–	○	○	0.05 – 0.34	0.07 – 0.38
90°	652.216.WW.05	○	–	–	○	○	0.03 – 0.19	0.04 – 0.20
	652.246.WW.05	○	–	–	○	○	0.04 – 0.30	0.06 – 0.33
	652.276.WW.05	○	–	–	○	○	0.05 – 0.35	0.07 – 0.40
	652.306.WW.05	○	○	–	–	○	–	0.09 – 0.59
	652.336.WW.05	○	○	–	–	○	–	0.11 – 0.72
	652.366.WW.05	○	○	–	–	○	–	0.13 – 0.92
120°	652.187.WW.05	○	–	–	○	○	0.02 – 0.14	0.03 – 0.15
	652.217.WW.05	○	–	–	○	○	0.03 – 0.20	0.04 – 0.21
	652.247.WW.05	○	–	–	○	○	0.04 – 0.29	0.05 – 0.31
	652.277.WW.05	○	–	–	○	○	0.05 – 0.36	0.07 – 0.41
	652.307.WW.05	○	–	–	–	○	–	0.09 – 0.58
	652.337.WW.05	○	○	–	–	○	–	0.11 – 0.73
	652.367.WW.05	○	○	–	–	○	–	0.13 – 0.95

* PWM: Pulse width modulation

** Spray angle can differ in PWM operation

*** DC: 10 – 90 %, fluid pressure: 4 – 7 bar, frequency: 50 Hz, DC = Pulse width ratio %

COMPONENTS AND COMBINATION OPTIONS

VarioSpray HP



Single valve

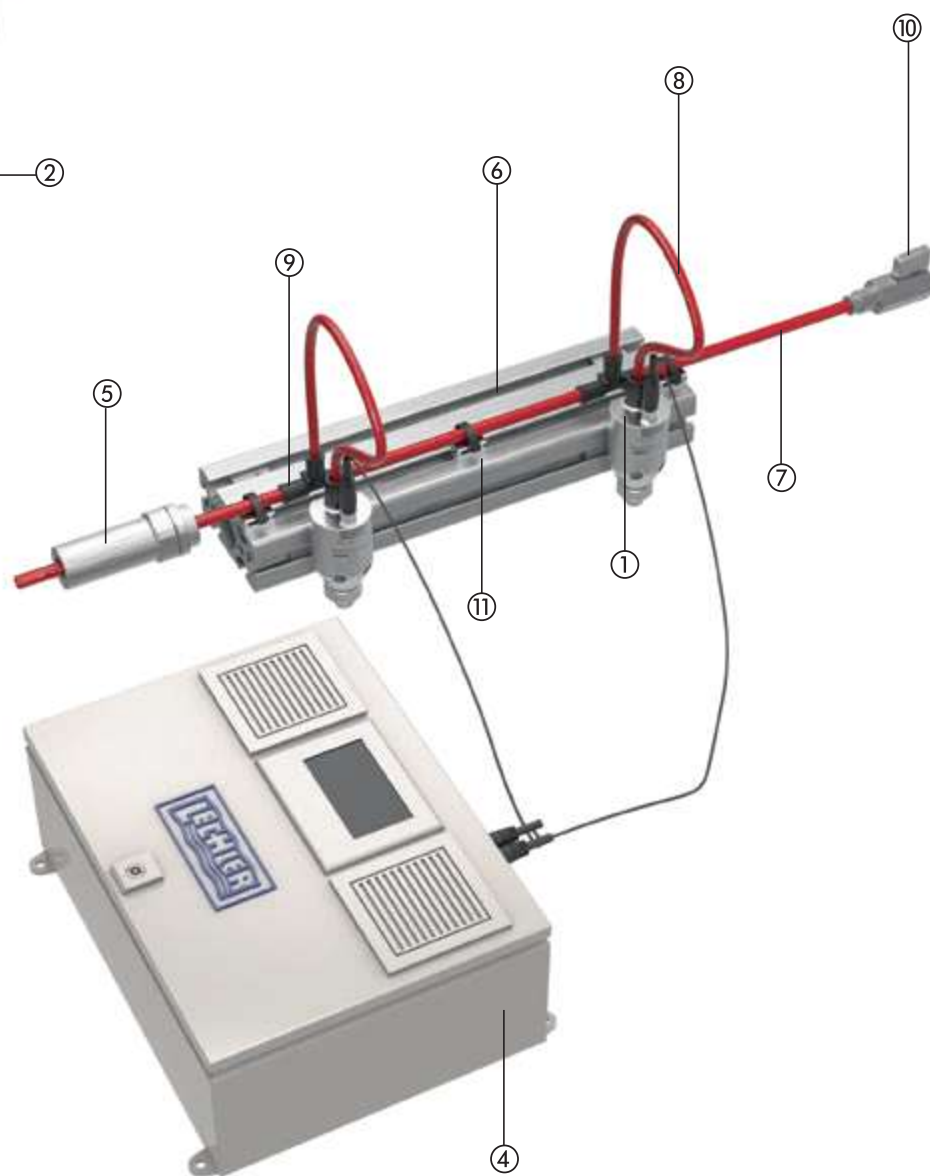

Combination example

COMPONENTS AND COMBINATIONS

Version	No.	Description	Ordering no.	Technical specification	Length
Valves	①	Valve, incl. retaining nut, connecting nipple, packaging, manual, O-ring FDA-compliant	752.060.1Y.00	DN 0.6 mm; 12 V, peak-and-hold control; for further technical data see Page 8/9	
	①	Valve, incl. retaining nut, connecting nipple, packaging, manual, FDA-compliant	752.090.1Y.00	DN 0.9 mm; 12 V, peak-and-hold control; for further technical data see Page 8/9	
Basic analog control		Siemens S7-1200 controller for control cabinet installation, incl. pre-installed software package	075.270.00.00	on USB stick, control: Siemens S7 1200 / control of up to 16 valves, all valves switched simultaneously	
		Power driver	075.281.00.00	max. 4 valves per power driver	
SMART control	④	SMART control	075.270.00.10	Control unit for up to 8 VarioSpray HP valves, simultaneous switching of all valves, see Page 18 for technical details	
FLEX control	④	FLEX control	075.270.00.20	Control unit for up to 16 VarioSpray HP valves, individual valve control possible, see Page 18 for technical details	
Components for VarioSpray HP	②	Nozzle	652.XXX.WW.05	See Page 9 for possible sizes	
	③	Valve cable, M8 - M8	075.280.00.00	Retaining nut, material: 316L SS	5 m
	③	Valve cable, M8 - M8	075.280.00.01	Retaining nut, material: 316L SS	10 m
		Valve filter	075.250.1Y.00	Mesh size: 80 µm, max. pressure 10 bar, material: 316L SS/Viton/adhesive-free, connection: 1/8 BSPP x 1/8 BSPP	
	⑤	Filter for central liquid line	074.217.1Y.00	for up to 8 valves** / Mesh size: 40 µm, max. pressure 10 bar, material: 316L SS/Viton/adhesive-free, connection: 3/8 BSPP	
	⑥	ITEM profile, 80 x 40	074.215.40.00	incl. T-slot nuts, screws, caps, universal holder, Material: Aluminum	1 m
	⑥	ITEM profile, 80 x 40	074.215.40.01	incl. T-slot nuts, screws, caps, universal holder, Material: Aluminum	2 m
	⑦	Central liquid supply line*	075.290.00.00	Hose dia. 22, material: LLDPE blue	10 m
	⑧	Valve hose to the valves	074.213.54.01	Hose dia. 8, material: LLDPE natural	5 m
	⑨	Hose fitting set	075.290.56.50	set components: reducing tee (22 x 22 x 15) 2 x reducer (15 x 12 and 12 x 8); material: POM	
	⑩	Ventilation set	075.290.56.51	set components: reducing tee (22 x 22 x 15); 2 x reducer (15 x 12 and 12 x 8); 1 x shut-off valve; 1 x plug; material: POM	
	⑪	Tube clamp	075.230.00.10	for hose dia. 22	
		Backflush nipple	075.210.1Y.00	G 3/8 on hose dia. 8 mm, material: 316L SS	
		Expansion set for valve mounting	075.230.00.00	T-slot nuts (25 ea), screws (16 ea. M4 x 30), universal holders (10 ea.)	

* FDA-compliant, EC 1935/10/2011 on request

** Other filters on request

Ordering information

The above table shows the VarioSpray HP versions recommended by Lechler.

Please specify the required individual components when ordering.

The available nozzles are listed in the table on Page 9. Please specify the corresponding nozzle number when ordering.

DN = Nominal diameter

Questionnaire:

www.lechler.de/variospray/fragebogen_variospray
www.lechler.com/variospray/questionnaire_variospray

Control unit for VarioSpray HP

The two VarioSpray HP control unit versions with clearly understandable color displays permit optimal valve control in line with your requirements.

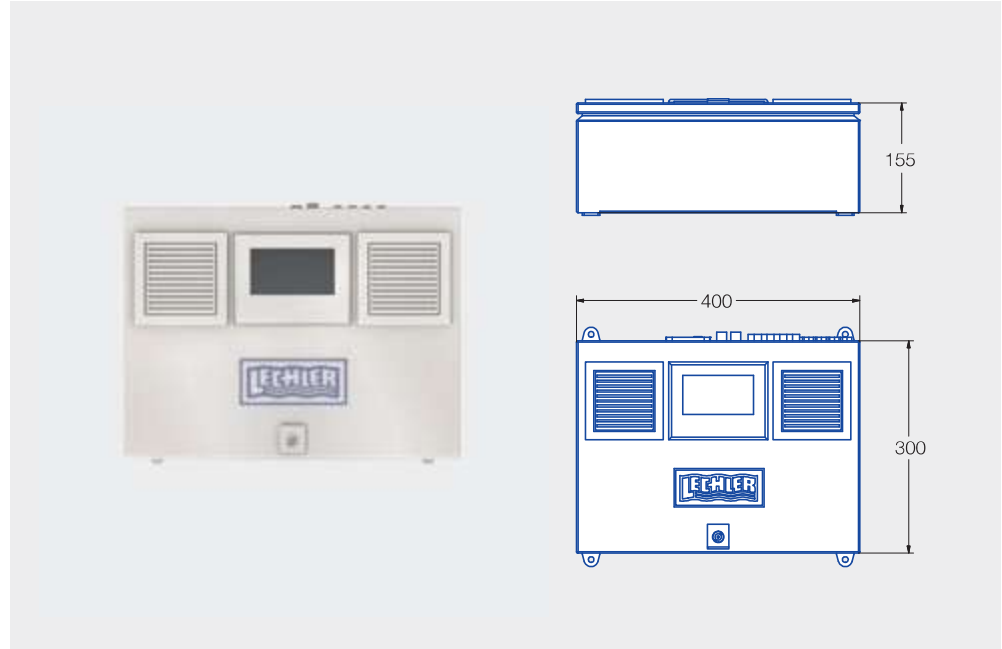

SMART

The SMART valve control unit is an economical version for valves in the HP range. It permits simultaneous control of all valves for easy operation.

Benefits:

- Easy operation
- Simultaneous control of all connected valves
- Control software ideally matched to the valves
- Clear 4.3" color touch display
- 4 direct control buttons for fast access

FLEX

The FLEX control unit is characterized by flexibility – the VarioSpray HP valves can be controlled and the flow rate regulated individually. This feature is ideal for applications in which different belt widths occur in the production process.

Benefits:

- Straightforward operation
- Individual control of all valves via software switches
- Control software ideally matched to the valves
- Clear 4.3" color touch display
- 4 direct control buttons for fast access

	SMART	FLEX
Maximum number of valves	8	16
Individual valve control	No	Yes
Frequency	10 / 20 / 30 / 40 / 50 / 75 / 100 / 200 Hz	
Supply voltage	100 – 240 V AC	
Total power	240 W	
Control voltage	12 – 24 V DC / Peak-and-hold control	
Pulse width	3 – 98 %	
Lag time	0 – 99.9 s	
Lead time	0 – 99.9 s	
External signal input	Yes	
Protection type	IP 54	
Display	4.3" color touch panel	
Electrical connection for valves	M8 3-pin circular connector	

Ordering data
Control unit SMART
Control unit FLEX

Ordering no.
075.270.00.10
075.270.00.20